



MAINTENANCE INSTRUCTIONS



The purchaser must instruct all operators on the proper use of the equipment. All standard industrial safety measures and equipment should be provided to protect the operator. Operators must be cautioned that improper use of this equipment can cause bodily injury. If you do not have qualified operators to instruct new persons, contact your Eastman sales representative or write to Eastman Machine factory direct.

CAUTION

Read instructions carefully before starting motor. Be sure that voltage and current are the same as stamped on nameplate. All Eastman machines shown in this catalogue are equipped with sharp blades and extreme caution should be used when this machine is put into use. Use control levers and handles only when operating or handling machine. When machine is not in operation the front knife guard should be kept in the lowered position. When making a cut the knife guard should be raised only enough to clear the material being cut. When this equipment is not being utilized, the power supply should be disconnected from the equipment.

TO OPERATE MACHINE

Turn the switch to the on position; if cutter does not start immediately, return the switch to the off position. Check the line output and be sure that the unit is plugged in properly and is making full contact, then repeat procedure. Do not attempt to start this unit while it is in the material being cut.

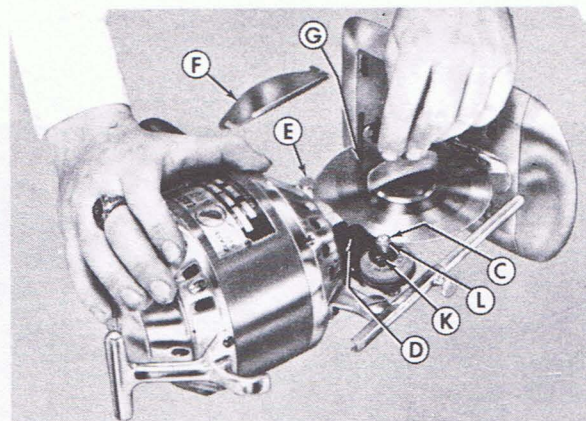

SPANNER WRENCH

SMALL PIN

WARNING

Before performing any of the following procedures, make sure that the attachment plug has been disconnected from power source.

MAINTENANCE PROCEDURES

- 1 Be sure that the rollers of the base plate are kept lint free.
- 2 Be sure that the terminal pins on the terminal block are kept in good condition to make full contact with the female receptacle.
- 3 Inspect the operating switch periodically to make sure that it is making full contact when in the on position.
- 4 When replacing the knife on this cutting unit, be sure that any lint build-up between the knife and the standard is cleaned out.
- 5 If the cutting unit seems to lag while not cutting, the knife should be removed and the unit should be run without the knife to see if the machine has been over-greased or if there is an obstruction somewhere.

TO REPLACE THE KNIFE

Loosen thumb screw "E" and swing guard "F" to outward position as shown on dotted lines. Turn the knife so the small hole lines up with hole "G" in the standard. Insert the small pin that is with the supplies in hole "G". Remove the lock nut that retains the blade with the special spanner wrench. When installing a new knife, be sure the name Eastman Machine Company is facing outward and that the knife seats on the knife gear. Install knife lock nut and be sure that the throat plate is adjusted as outlined.

CAUTION

Discard used sharp knives with care.

TO ADJUST THROAT PLATE

It is very important that the edge of the knife be as close as possible without touching to the forward position in the slot on the throat plate. The slot in the throat plate "J" should straddle the blade and screws "H" can be loosened and retightened to accomplish this adjustment.



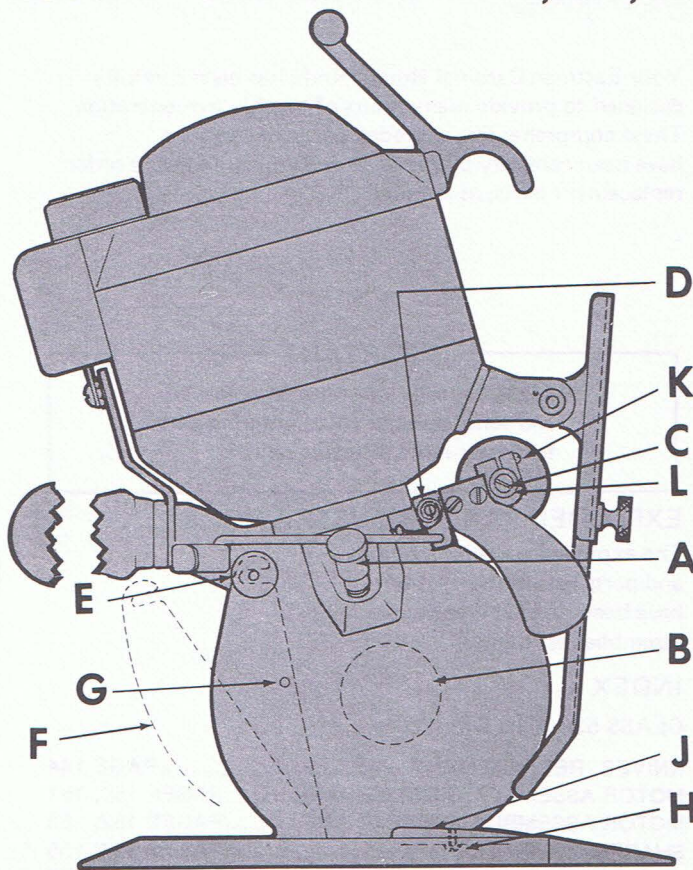

CAUTION

Do not use sewing machine oil or detergent oil. It is entirely too light for cutting machine lubrication. For best results use specially compounded Eastman Oil or at least a good grade of No. 30 motor oil. Do not oil Base Plate Rollers.

REPLACEMENT KNIVES

Knife Diameter	Carbon Steel	High Speed Steel	High Speed Steel Grooved	High Speed Steel Teflon Coated	Model Used On
5-1/2	80C1-26	-	-	-	-
4	80C1-59	80C1-59 HS	80C1-59 HSG	80C1-59 HST	534, 548
5	80C1-101	80C1-101 HS	80C1-101 HSG	80C1-101 HST	534, 548
5-1/4	80C1-61	80C1-61 HS	80C1-61 HSG	80C1-61 HST	548
6	80C1-39	80C1-39 HS	80C1-39 HSG	80C1-39 HST	548, 562
7-1/2	80C1-77/100	80C1-77/100 HS	80C1-77/100 HSG	80C1-77/100 HST	562

Knife Diameter	Carbon Slotted	Double-Bevel Hi-Speed
7-1/2	80C1-120	80C1-154

LUBRICATION

TWICE A DAY

Oil emery wheel spindles at "C".
DO NOT USE AN EXCESS AMOUNT OF OIL.

ONCE A DAY

Lubricate gears, screw grease cup "A" down one-half turn. Refill cup, as required with Eastman Gear Lubricant special formula (242C2).

ONCE A MONTH

Grease knife gear bearing at "B", remove bearing locknut with spanner wrench and a small amount of Eastman Lubriko grease (242C2-2) from tube.

We recommend our Eastman Gear Lubricant special formula (242C2) for gears and Eastman Lubriko grease (242C2-2) for knife gear ball bearing. Do not use Eastman Gear Lubricant for ball bearings or Eastman Lubriko grease for gears.

TO ADJUST EMERY WHEELS

As the Emery Wheels wear away and become farther apart, they must be adjusted. Adjust Emery Wheels from both sides to assure proper centering of the wheels over the knife. Proceed as follows:

- 1 Loosen slotted head screws "K".
- 2 With fingers, turn adjusting bushings "L" until Emery Wheels are as close together as possible without touching and are centered over the knife. Both wheels should grind at the same time when pressed lightly against the knife and there should be no more than 1/32-inch clearance between the two Emery Wheels.
- 3 Tighten slotted head screws "K".

TO REPLACE EMERY WHEELS

- 1 With front of machine facing serviceman, guard rod in down safe position, remove right hand grinding wheel and arm by loosening setscrew "D" and sliding arm off shaft.

- 2 Remove slotted head screw "C" and replace grinding wheel with spindle in right hand arm.
- 3 No need to remove left hand arm from machine. Remove slotted head screw "C" from left hand arm and replace grinding wheel with spindle.
- 4 Re-assemble right hand arm to shaft and adjust wheels to knife as covered above.

Eastman
machine
COMPANY



ILLUSTRATED PARTS LIST



ROUND KNIFE MACHINES

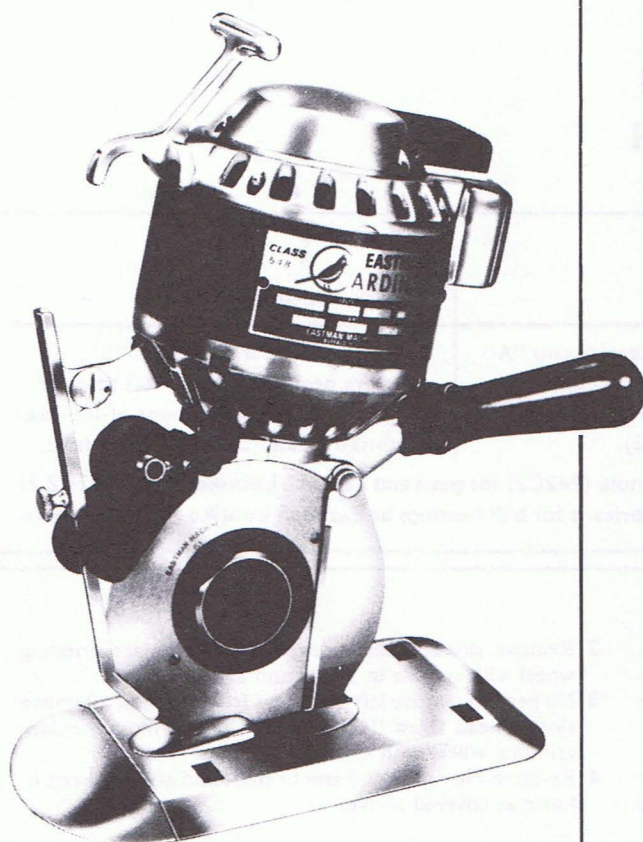

ALL PARTS SHOWN ON EXPLODED PARTS
ILLUSTRATIONS ARE COMMON TO 548 AND
534 MODELS EXCEPT AS NOTED BY SYMBOLS.

*PARTS REQUIRED FOR MODEL 534 ONLY
†PARTS REQUIRED FOR MODEL 548 ONLY

Your Eastman Cardinal Round Knife has been carefully designed to provide many hours of trouble free operation. These comprehensive exploded parts illustrations have been carefully prepared to enable you to easily order replacement parts, as required.

IMPORTANT

Always specify machine class number
and serial number when ordering parts
for faster more efficient service.

EXPLODED PARTS ILLUSTRATIONS

The exploded parts illustrations
and parts lists in this section
have been divided into major
assemblies as follows:

INDEX

CLASS 534 AND 548

KNIVES, REPLACEMENT	PAGE 144
MOTOR ASSEMBLY, SINGLE PHASE	PAGES 150, 151
MOTOR ASSEMBLY, THREE PHASE	PAGES 152, 153
SHARPENER ASSEMBLY	PAGES 154, 155
STANDARD ASSEMBLY	PAGES 156, 157
GUARD ASSEMBLY	PAGES 158, 159
BASE PLATE ASSEMBLY	PAGES 158, 159
BK & CARPET CUTTER	PAGES 160, 161
TERMINAL BLOCK, ATTACHMENT PLUG	PAGE 162
CLASS 562	PAGE 163

FASTENERS REQUIRED TO ASSEMBLE MAJOR COMPONENTS

Part No.	Description
20C8-2	SHARPENER LEVER SCREW
20C13-72 . . .	SCREW, BASE PLATE TO STANDARD (3 Req'd.)
300C12-3	SCREW, 8-32 x 3/8 RD. HD. (2 Req'd.)
301C14-5	SCREW, 10-24 x 3/4 FILLISTER HD. (3 Req'd.)
302C12-3	SCREW, 8-32 x 3/8 FLAT HD. (2 Req'd.)



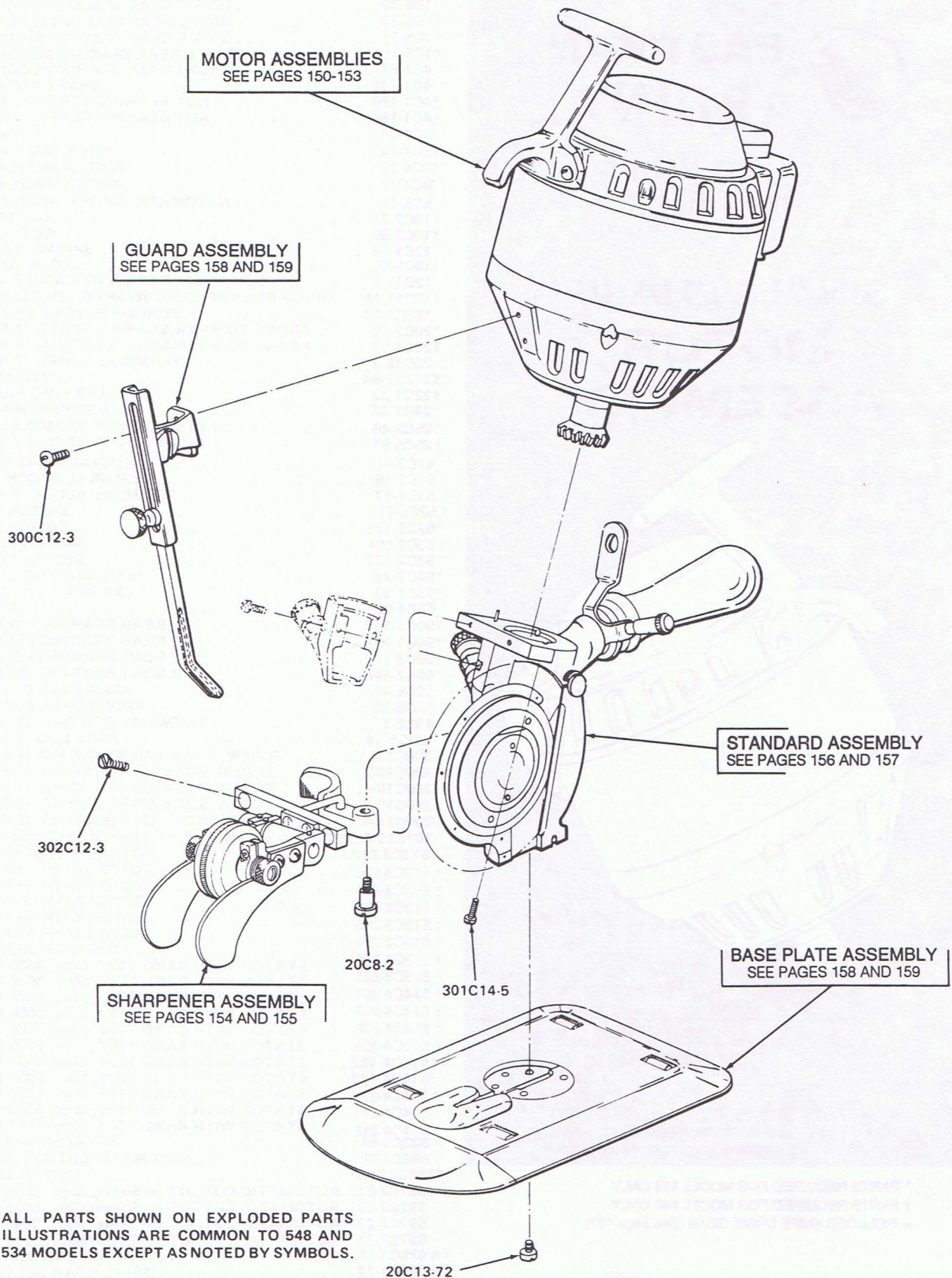

Eastman Cardinal Class 534, 548, and 562 Round Knife Machines Parts List



ROUND KNIFE MACHINES

SINGLE PHASE MOTOR ASSEMBLY

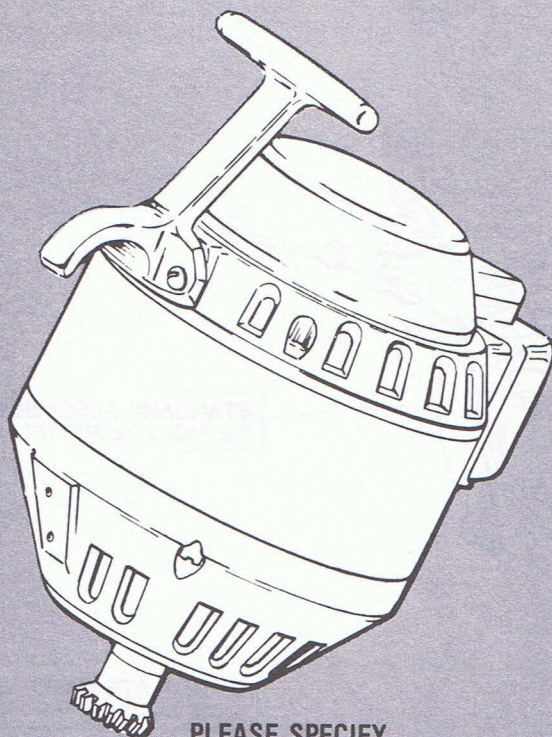

PLEASE SPECIFY
MACHINE CLASS NUMBERS
AND SERIAL NUMBER WHEN
ORDERING PARTS

ALL PARTS SHOWN ON EXPLODED PARTS
ILLUSTRATIONS ARE COMMON TO 548 AND
534 MODELS EXCEPT AS NOTED BY SYMBOLS.

- * PARTS REQUIRED FOR MODEL 534 ONLY
- † PARTS REQUIRED FOR MODEL 548 ONLY
- * INCLUDES KNIFE DRIVE GEAR (See page 157)

Part No.	Description
†1C5-30	DRIVE GEAR SPACING SLEEVE 52H
†1C5-31	DRIVE GEAR SPACING SLEEVE 6H

Part No.	Description
1C5-32	DRIVE GEAR SPACING SLEEVE 4H
†1C5-33	DRIVE GEAR SPACING SLEEVE 5H
†1C5-34	DRIVE GEAR SPACING SLEEVE 6L
†1C5-36	DRIVE GEAR SPACING SLEEVE 52L
4C1-87	FRONT BALL BEARING LOCK NUT
4C1-118	SHAFT LOCK NUT
*4C1-180	NUT BEARING SCREW (4 Req'd.)
†4C1-186	NUT BEARING SCREW (4 Req'd.)
†4C2-91	LEVER NUT
†8C4-14	SWITCH INSULATION
*8C4-20	SWITCH INSULATION
8C4-72	SWITCH INSULATION
8C5-10	AUTOMATIC SWITCH INSULATION
†10C2-27	ROTOR FAN
*10C2-30	ROTOR FAN
12C1-12	SPRING WASHER
12C1-32	LOCK WASHER
12C11-17	DRIVE GEAR SPACING WASHER 4H/5H
†12C11-18	DRIVE GEAR SPACING WASHER 52H/52L/6H/6L
199C1-19	TONGUE RINGS 4-1PH/7-3PH
*20C3-30	FRONT TO REAR BEARING SCREW (4 Req'd.)
†20C3-31	FRONT TO REAR BEARING SCREW (4 Req'd.)
20C12-2	TERMINAL SCREW (2 Req'd.)
†20C12-64	LEVER SCREW
†22C1-32	CARRYING HANDLE
*22C1-33	CARRYING HANDLE
*25C5-48	GUARD OVER TERMINAL PINS
†25C5-57	GUARD OVER TERMINAL PINS
47C2-4	TERMINAL PIN (2 Req'd.)
51C1-16	TERMINAL BLOCK (Top)
51C1-17	TERMINAL BLOCK (Bottom)
†52C5-171	SWITCH BASE
*52C5-175	SWITCH BASE
†53C2-104	SWITCH COVER
*53C2-107	SWITCH COVER
†53C7-36	REAR BEARING COVER
*53C7-39	REAR BEARING COVER
55C4-99	SPACER
†90C1-153	REAR BEARING HOUSING
*90C1-158	REAR BEARING HOUSING
†90C2-143	FRONT BEARING HOUSING
*90C2-146	FRONT BEARING HOUSING
90C6-46	REAR BALL BEARING
90C6-29	FRONT BALL BEARING
93C2-1	TERMINAL CONTACT (2 Req'd.)
199C1-19	WIRE LUG (4 Req'd.)
300C7-2	SCREW, 4-36 x 3/16 ROUND HD. (2 Req'd.)
300C10-2	SCREW, 6-32 x 1/4 ROUND HD. (2 Req'd.)
300C10-4	SCREW, 6-32 x 3/8 ROUND HD. (2 Req'd.)
300C12-3	SCREW, 8-32 x 3/8 ROUND HD. (2 Req'd.)
300C14-4	SCREW, 10-24 x 1/2 ROUND HD. (2 Req'd.)
301C10-3	SCREW, 6-32x3/8 FILL HD. (2Req'd 534) (3Req'd 548)
†513C3-210	ROTOR WITH SHAFT 52H
†513C3-230	ROTOR WITH SHAFT 52L
†513C3-231	ROTOR WITH SHAFT 4H
†513C3-232	ROTOR WITH SHAFT 5H
†513C3-233	ROTOR WITH SHAFT 6H
†513C3-234	ROTOR WITH SHAFT 6L
†513C3-235	ROTOR WITH SHAFT 4H
*513C3-221	STATOR WITH BAND 110V, 60cy, 3600 R.P.M.
†514C4-206	STATOR WITH BAND 220V, 60cy, 3600 R.P.M.
†514C4-207	STATOR WITH BAND 220V, 50cy, 3000 R.P.M.
†514C4-208	STATOR WITH BAND 110V, 50cy, 3000 R.P.M.
†514C4-209	STATOR WITH BAND 110V, 60cy, 3600 R.P.M.
*514C4-122	STATOR WITH BAND 220V, 60cy, 3600 R.P.M.
*514C4-123	STATOR WITH BAND 220V, 50cy, 3000 R.P.M.
†514C4-210	STATOR WITH BAND 110V, 50cy, 1500 R.P.M.
†514C4-211	STATOR WITH BAND 110V, 60cy, 1800 R.P.M.
†514C4-212	STATOR WITH BAND 220V, 50cy, 1500 R.P.M.
523C1-51	ATTACHMENT PLUG
580C1-70	AUTOMATIC CUTOUT SWITCH
†580C1-85	MOTOR SWITCH
597C2-21	AUTOMATIC CUTOUT (w/Sleeve) 60cy, 3600 R.P.M.
597C2-22	AUTOMATIC CUTOUT (w/Sleeve) 50cy, 3000 R.P.M.
597C2-23	AUTOMATIC CUTOUT (w/Sleeve) 60cy, 1800 R.P.M.
597C2-24	AUTOMATIC CUTOUT (w/Sleeve) 50cy, 1500 R.P.M.
†★675C1-11	DRIVE GEAR SET 4H/5H
†★675C1-14	DRIVE GEAR SET 52H/6H
★675C1-15	DRIVE GEAR SET 52L/6L
783C1-3	GROUND WIRE
305C10-1	SCREW, 6-32 x 1/4 BIND HD.



Eastman Cardinal Class 534, 548, and 562 Round Knife Machines Parts List

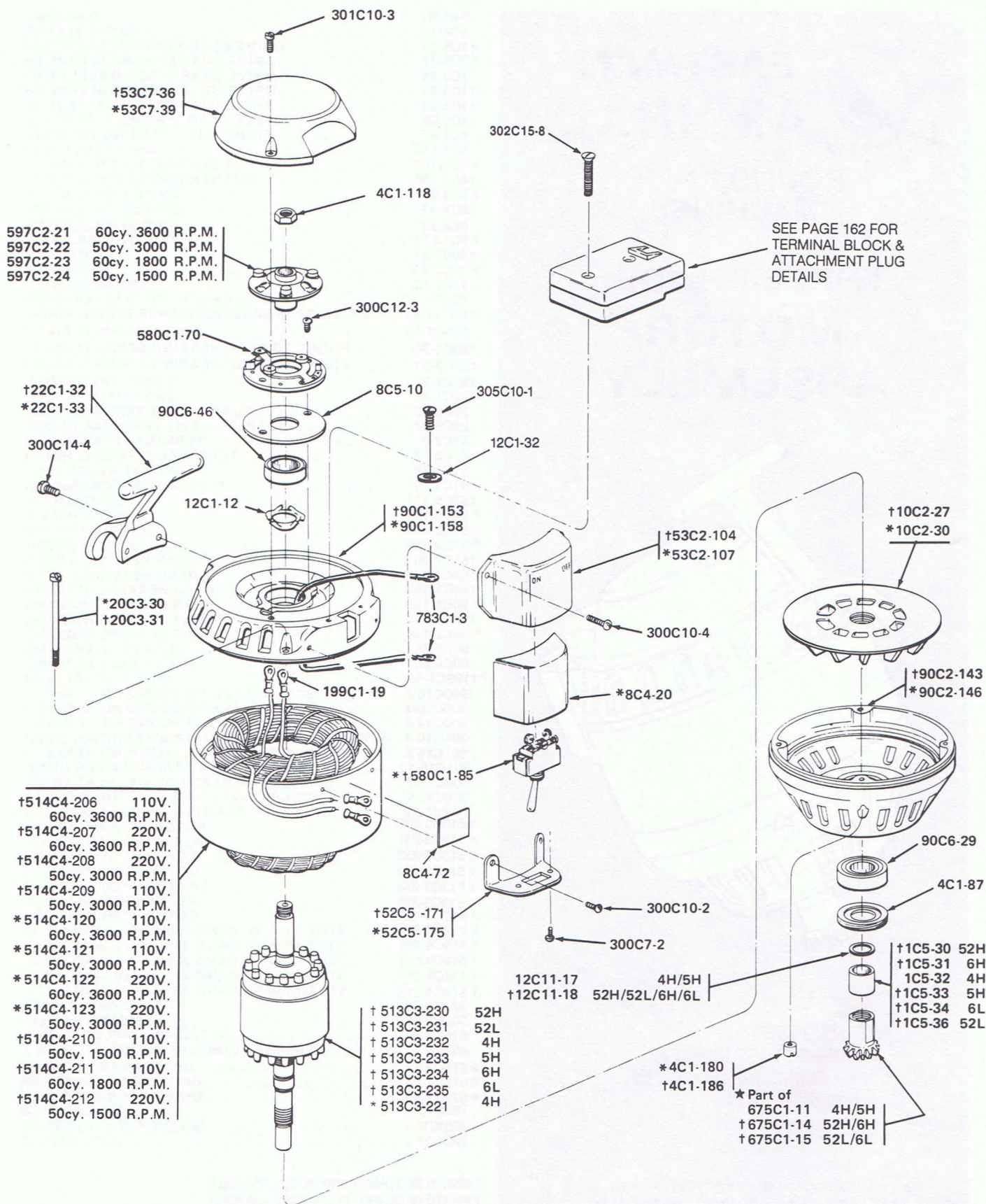

ALL PARTS SHOWN ON EXPLODED PARTS ILLUSTRATIONS ARE COMMON TO 548 AND 534 MODELS EXCEPT AS NOTED BY SYMBOLS.

* PARTS REQUIRED FOR MODEL 534 ONLY
 † PARTS REQUIRED FOR MODEL 548 ONLY
 * INCLUDES KNIFE DRIVE GEAR (See page 157)





ROUND KNIFE MACHINES

THREE PHASE MOTOR ASSEMBLY

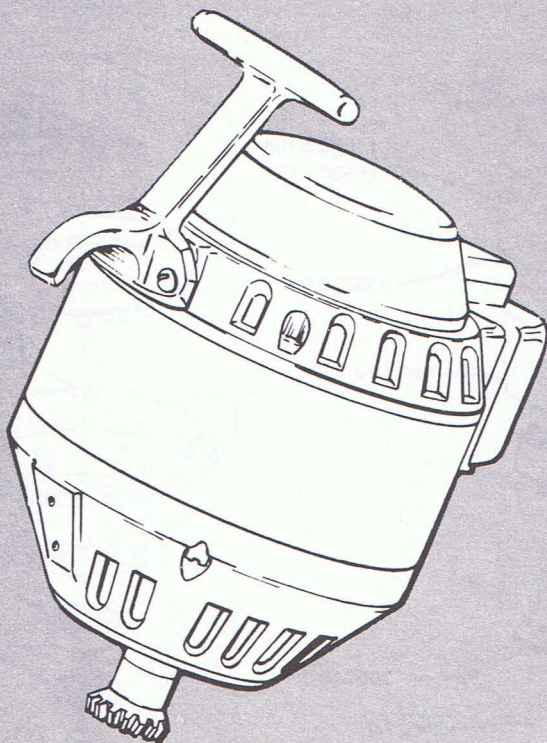

PLEASE SPECIFY
MACHINE CLASS NUMBERS
AND SERIAL NUMBER WHEN
ORDERING PARTS

ALL PARTS SHOWN ON EXPLODED PARTS
ILLUSTRATIONS ARE COMMON TO 548 AND
534 MODELS EXCEPT AS NOTED BY SYMBOLS.

Part No.	Description
1C4-10	SPACING SLEEVE
†1C5-30	DRIVE GEAR SPACING SLEEVE 52H
†1C5-31	DRIVE GEAR SPACING SLEEVE 6H
1C5-32	DRIVE GEAR SPACING SLEEVE 4H
†1C5-33	DRIVE GEAR SPACING SLEEVE 5H
†1C5-34	DRIVE GEAR SPACING SLEEVE 6L
†1C5-36	DRIVE GEAR SPACING SLEEVE 52L
4C1-87	FRONT BALL BEARING LOCKNUT
4C1-118	SHAFT LOCK NUT
*4C1-180	NUT BEARING SCREW (4 Req'd.)
†4C1-186	NUT BEARING SCREW (4 Req'd.)
*8C4-20	SWITCH INSULATION
†8C4-41	SWITCH INSULATION
8C4-72	SWITCH INSULATION
*8C13-71	COVER INSULATION
†10C2-27	ROTOR FAN
*10C2-30	ROTOR FAN
12C1-12	SPRING WASHER
12C11-17	DRIVE GEAR SPACING WASHER 4H/5H
†12C11-18	DRIVE GEAR SPACING WASHER 52H/52L/6H/6L
199C1-19	TONGUE RING (7 Req'd.)
*20C3-30	FRONT TO REAR BEARING SCREW (4 Req'd.)
†20C3-31	FRONT TO REAR BEARING SCREW (4 Req'd.)
†22C1-32	CARRYING HANDLE
*22C1-33	CARRYING HANDLE
25C5-60	GUARD OVER TERMINAL PINS
29C6-67	ADAPTER - 3 PH TERMINAL BLOCK
47C2-9	TERMINAL PIN (3 Req'd.)
47C3-17	TERMINAL SLEEVE (3 Req'd.)
51C1-18	TERMINAL BLOCK (Top)
51C1-19	TERMINAL BLOCK (Bottom)
†52C5-171	SWITCH BASE
*52C5-175	SWITCH BASE
†53C2-104	SWITCH COVER
*53C2-107	SWITCH COVER
†53C7-36	REAR BEARING COVER
*53C7-40	REAR BEARING COVER
†90C1-153	REAR BEARING HOUSING
*90C1-156	REAR BEARING HOUSING
†90C2-143	FRONT BEARING HOUSING
*90C2-146	FRONT BEARING HOUSING
90C6-28	REAR BALL BEARING
90C6-29	FRONT BALL BEARING
*†199C1-19	WIRE LUG (4 Req'd.)
300C10-2	SCREW, 6-32 x 1/4 ROUND HD. (2 Req'd.)
300C10-4	SCREW, 6-32 x 3/8 ROUND HD. (2 Req'd.)
300C14-4	SCREW, 10-24 x 1/2 ROUND HD. (2 Req'd.)
301C10-3	SCREW, 6-32x3/8 FILL.HD.(2Req'd 534)(3Req'd 548)
301C15-8	SCREW, 10-32 x 1-3/8 FILLISTER HD. (2 Req'd.)
301C15-12	SCREW 10-32 x 1-1/8 FILLISTER HEAD
302C15-7	SCREW 10-32 x 1" FLAT HEAD
302C15-9	SCREW, 10-32 x 1-1/4 FLAT HD. (2 Req'd.)
508C1-22	TERMINAL BLOCK COMPLETE
†513C3-230	ROTOR WITH SHAFT 52H
†513C3-231	ROTOR WITH SHAFT 52L
†513C3-232	ROTOR WITH SHAFT 4H
†513C3-233	ROTOR WITH SHAFT 5H
†513C3-234	ROTOR WITH SHAFT 6H
†513C3-235	ROTOR WITH SHAFT 6L
*513C3-221	ROTOR WITH SHAFT 4H
†514C4-213	STATOR WITH BAND 220V. 60cy. 3600 R.P.M.
*514C4-124	STATOR WITH BAND 220V. 60cy. 3600 R.P.M.
*514C4-125	STATOR WITH BAND 220V. 50cy. 3000 R.P.M.
†514C4-214	STATOR WITH BAND 220V. 50cy. 3000 R.P.M.
†514C4-215	STATOR WITH BAND 220V. 60cy. 1800 R.P.M.
523C1-38	ATTACHMENT PLUG
580C1-65	MOTOR SWITCH
615C1-5	ATTACHMENT PLUG CLAMP
667C1-1	TERMINAL CONTACT WITH PIN (3 Req'd.)
*675C1-11	DRIVE GEAR SET 4H/5H
†*675C1-14	DRIVE GEAR SET 52H/6H
†*675C1-15	DRIVE GEAR SET 52L/6L
783C1-3	GROUND WIRE
3051C10-1	SCREW, 6-32 x 1/4 BIND HD.
12C1-32	LOCK WASHER

* PARTS REQUIRED FOR MODEL 534 ONLY

† PARTS REQUIRED FOR MODEL 548 ONLY

* INCLUDES KNIFE DRIVE GEAR (See page 157)



Eastman Cardinal Class 534, 548, and 562 Round Knife Machines Parts List

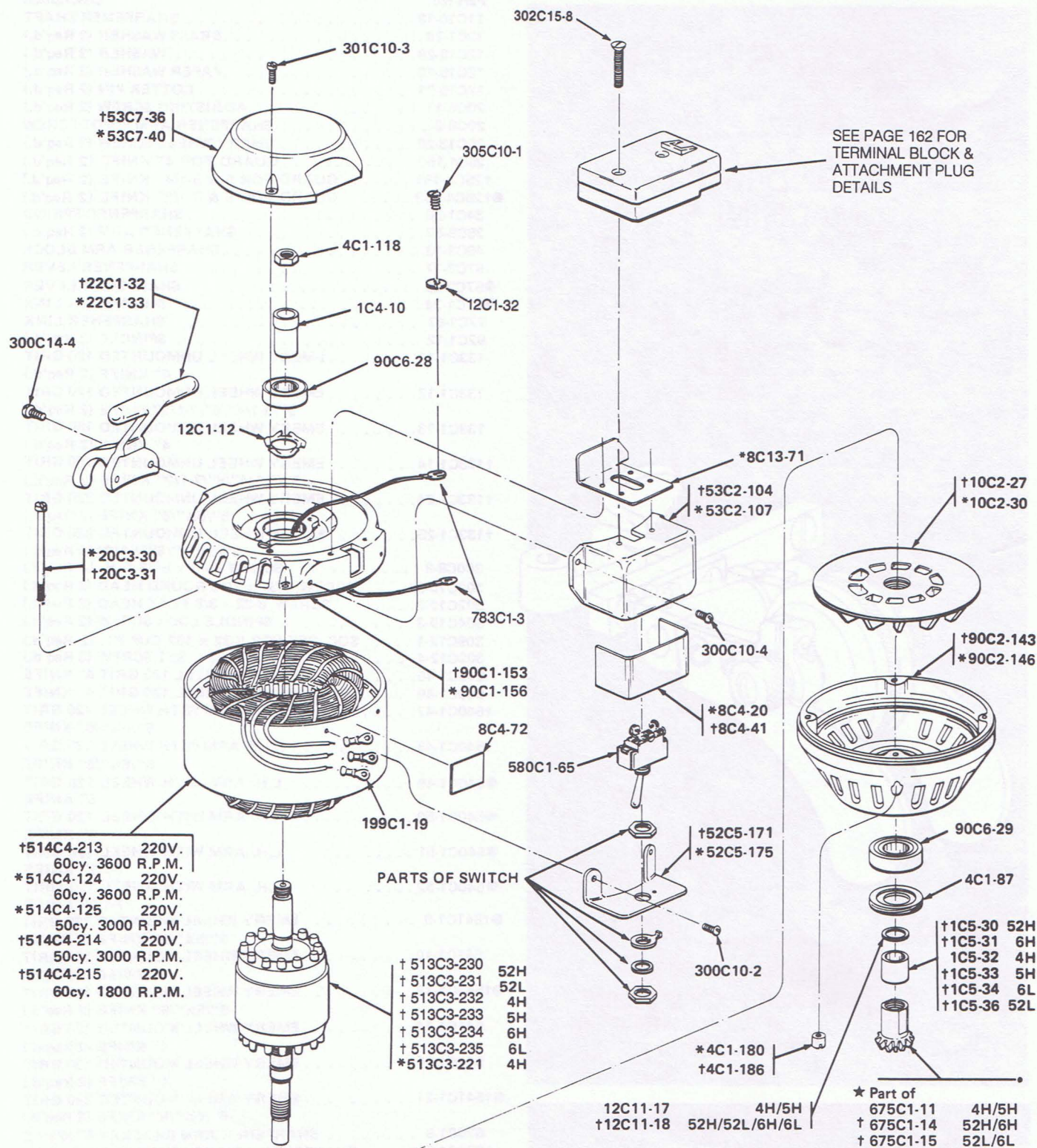

ALL PARTS SHOWN ON EXPLODED PARTS
ILLUSTRATIONS ARE COMMON TO 548 AND
534 MODELS EXCEPT AS NOTED BY SYMBOLS.

*PARTS REQUIRED FOR MODEL 534 ONLY
†PARTS REQUIRED FOR MODEL 548 ONLY





**ROUND KNIFE
MACHINES**

SHARPENER ASSEMBLY

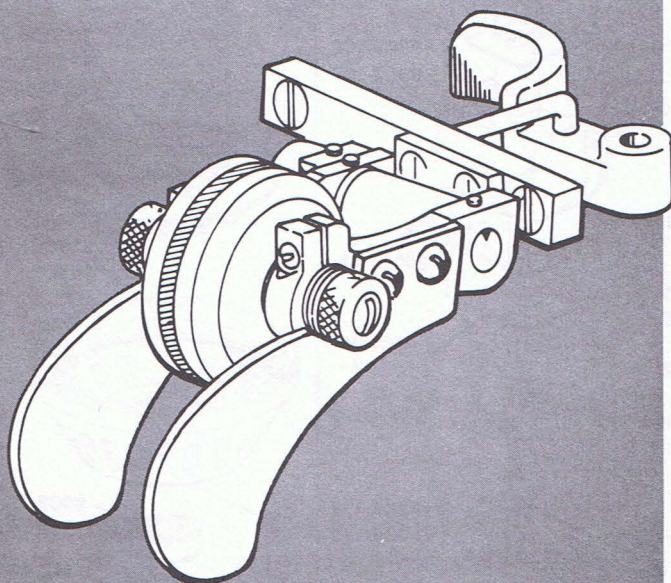

**PLEASE SPECIFY
MACHINE CLASS NUMBERS
AND SERIAL NUMBER WHEN
ORDERING PARTS**

ALL PARTS SHOWN ON EXPLODED PARTS
ILLUSTRATIONS ARE COMMON TO 534, 548, AND
562 MODELS EXCEPT AS NOTED BY SYMBOLS

*PARTS REQUIRED FOR MODEL 534 ONLY
†PARTS REQUIRED FOR MODEL 548 ONLY
●PARTS REQUIRED FOR MODEL 562 ONLY

Part No.	Description
11C10-18	SHARPENER SHAFT
12C1-28	BRASS WASHER (2 Req'd.)
12C15-29	WASHER (2 Req'd.)
12C15-70	PAPER WASHER (2 Req'd.)
17C15-71	COTTER PIN (2 Req'd.)
20C6-11	ADJUSTING SCREW (2 Req'd.)
20C8-2	SHARPENER ARM PIVOT SCREW
20C13-20	EMERY WHEEL SCREW (2 Req'd.)
25C4-160	GUARD FOR 4" KNIFE (2 Req'd.)
†25C4-161	GUARD FOR 5 & 5-1/4" KNIFE (2 Req'd.)
●†25C4-163	GUARD FOR 6 & 7-1/2" KNIFE (2 Req'd.)
34C1-20	SHARPENER SPRING
35C5-57	SHARPENER ARM (2 Req'd.)
46C3-13	SHARPENER ARM BLOCK
57C2-17	SHARPENER LEVER
●57C2-22	SHARPENER LEVER
●77C1-34	SHARPENER LINK
77C1-67	SHARPENER LINK
92C1-12	SPINDLE (2 Req'd.)
133C1-11	EMERY WHEEL UNMOUNTED 120 GRIT 4" KNIFE (2 Req'd.)
133C1-12	EMERY WHEEL UNMOUNTED 120 GRIT 5"/5-1/4"/6"/7-1/2" KNIFE (2 Req'd.)
133C1-13	EMERY WHEEL UNMOUNTED 150 GRIT 4" KNIFE (2 Req'd.)
†133C1-14	EMERY WHEEL UNMOUNTED 150 GRIT 5"/5-1/4"/6"/7-1/2" KNIFE (2 Req'd.)
†133C1-24	EMERY WHEEL UNMOUNTED 220 GRIT 5"/5-1/4"/6" KNIFE (2 Req'd.)
†133C1-25	EMERY WHEEL UNMOUNTED 220 GRIT 5"/5-1/4"/6"/7-1/2" (2 Req'd.)
300C8-8	SCREW 4-40 x 5/16 R.H. (4 Req'd.)
300C10-5	SCREW, 6-32 x 7/16 ROUND HEAD (2 Req'd.)
302C12-3	SCREW, 8-32 x 3/8 FLAT HEAD (2 Req'd.)
304C10-3	SPINDLE LOCK SCREW (2 Req'd.)
309C12-1	SOC. SET SCR 8-32 x 187 CUP PT. (2 Req'd.)
309C12-4	SET SCREW (3 Req'd.)
540C1-45	L.H. ARM WITH WHEEL 120 GRIT 4" KNIFE
540C1-46	R.H. ARM WITH WHEEL 120 GRIT 4" KNIFE
†540C1-47	L.H. ARM WITH WHEEL 120 GRIT 5"/5-1/4"/6" KNIFE
†540C1-48	R.H. ARM WITH WHEEL 120 GRIT 5"/5-1/4"/6" KNIFE
●540C1-49	L.H. ARM WITH WHEEL 120 GRIT 6" KNIFE
●540C1-50	R.H. ARM WITH WHEEL 120 GRIT 6" KNIFE
●540C1-51	L.H. ARM WITH WHEEL 120 GRIT 7-1/2" KNIFE
●540C1-52	R.H. ARM WITH WHEEL 120 GRIT 7-1/2" KNIFE
●†541C1-9	EMERY WHEEL MOUNTED 120 GRIT 5"/5-1/4"/6" KNIFE (2 Req'd.)
541C1-10	EMERY WHEEL MOUNTED 120 GRIT 4" KNIFE (2 Req'd.)
●†541C1-13	EMERY WHEEL MOUNTED 150 GRIT 5"/5-1/4"/6" KNIFE (2 Req'd.)
541C1-14	EMERY WHEEL MOUNTED 150 GRIT 4" KNIFE (2 Req'd.)
541C1-20	EMERY WHEEL MOUNTED 220 GRIT 4" KNIFE (2 Req'd.)
●†541C1-21	EMERY WHEEL MOUNTED 220 GRIT 5"/5-1/4"/6" KNIFE (2 Req'd.)
636C1-8	SHARPENER ARM BRACKET 4" KNIFE
†636C1-9	SHARPENER ARM BRACKET 5" KNIFE (BK)
†636C1-10	SHARPENER ARM BRACKET 5-1/4" KNIFE
†636C1-11	SHARPENER ARM BRACKET 6" KNIFE
●636C1-13	SHARPENER ARM BRACKET 6x & 75x KNIFE
637C1-25	SHARPENER COMPLETE 4" KNIFE
637C1-26	SHARPENER COMPLETE 5" KNIFE
637C1-27	SHARPENER COMPLETE 5-1/4" KNIFE
637C1-28	SHARPENER COMPLETE 6" KNIFE
●637C1-30	SHARPENER COMPLETE 6x & 75x KNIFE



Eastman Cardinal Class 534, 548, and 562 Round Knife Machines Parts List

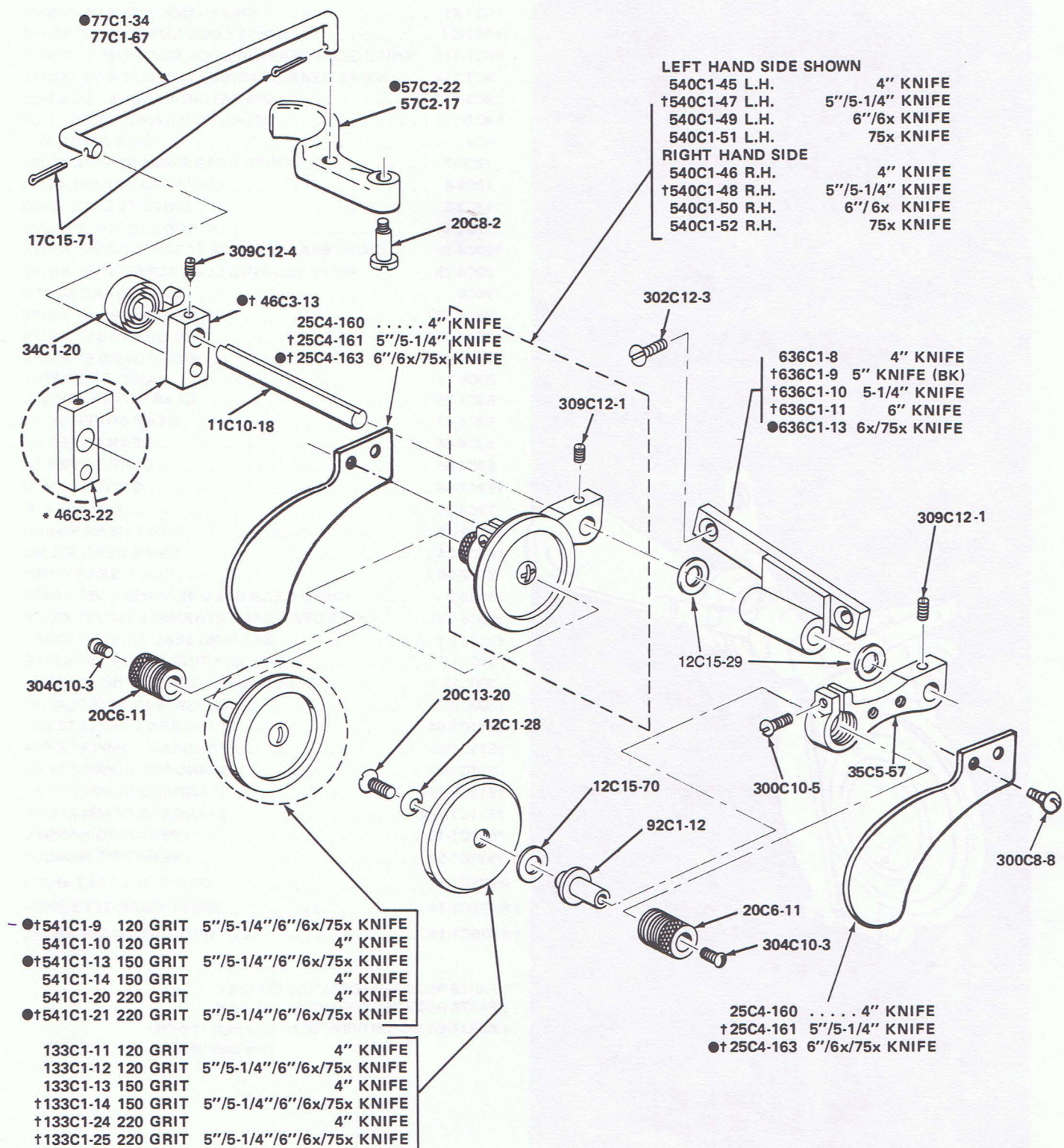

ALL PARTS SHOWN ON EXPLODED PARTS ILLUSTRATIONS ARE COMMON TO 534, 548, AND 562 MODELS EXCEPT AS NOTED BY SYMBOLS

*PARTS REQUIRED FOR MODEL 534 ONLY
†PARTS REQUIRED FOR MODEL 548 ONLY
●PARTS REQUIRED FOR MODEL 562 ONLY





**ROUND KNIFE
MACHINES**

STANDARD ASSEMBLY

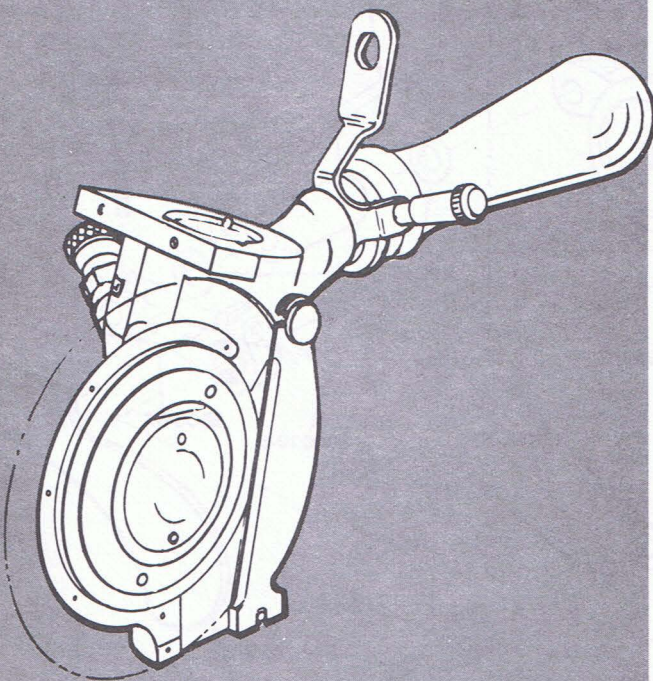

**PLEASE SPECIFY
MACHINE CLASS NUMBERS
AND SERIAL NUMBER WHEN
ORDERING PARTS**

ALL PARTS SHOWN ON EXPLODED PARTS
ILLUSTRATIONS ARE COMMON TO 548 AND
534 MODELS EXCEPT AS NOTED BY SYMBOLS.

Part No.	Description
4C1-81	KNIFE LOCK NUT 4"/5" KNIFE
†4C1-82	KNIFE LOCK NUT 5-1/4"/6" KNIFE
†4C1-113	KNIFE GEAR BEARING LOCK NUT 5-1/4"/6" KNIFE
4C1-114	KNIFE GEAR BEARING LOCK NUT 4"/5" KNIFE
†4C1-130	OPERATING HANDLE LOCK NUT
*4C1-115	OPERATING HANDLE LOCK NUT
4C4	SIDE GUIDE NUT
12C9-7	KNIFE GEAR SHIMS 52H/52L/6H/6L
12C9-8	KNIFE GEAR SHIMS 4H/5H
†13C2-5	SWITCH LEVER KNOB
17C1-4	STANDARD PIN (2 Req'd.)
†20C4-28	KNIFE BEARING LOCK SCREW 5-1/4"/6" KNIFE
20C4-29	KNIFE BEARING LOCK SCREW 4"/5" KNIFE
24C6	SIDE GUARD SCREW
†25C4-137	SIDE GUARD 4" KNIFE
†25C4-138	SIDE GUARD 5 1/2" KNIFE
†25C4-140	SIDE GUARD 6" KNIFE
29C6-141	HANDLE ADAPTER
53C4-36	GEAR COVER 52H/52L
53C4-47	GEAR COVER 6H/6L
53C4-64	GEAR COVER 4H
53C4-65	GEAR COVER 5H
†57C1-56	SWITCH LEVER
72C4-20	GREASE CUP
†87C2-21	KNIFE GEAR 52H/6H
†87C2-24	KNIFE GEAR 52L/6L
87C2-36	KNIFE GEAR 4H/5H
90C6-9	KNIFE GEAR BALL BEARING 4"/5" KNIFE
†90C6-33	KNIFE GEAR BALL BEARING 5-1/4"/6" KNIFE
†216C1-1	BEARING SEAL 5-1/4"/6" KNIFE
216C1-2	BEARING SEAL 4"/5" KNIFE
300C12-7	SCREW, 8-32 x 5/8 ROUND HD. (2 Req'd.)
†302C12-2	SCREW, 8-32 x 5/16 FLAT HD.
†511C1-94	STANDARD COMPLETE 52L
†511C1-96	STANDARD COMPLETE 52H
511C1-97	STANDARD COMPLETE 4H
†511C1-101	STANDARD COMPLETE 6H
†511C1-102	STANDARD COMPLETE 6L
*531C1-13	OPERATING HANDLE
†531C1-53	OPERATING HANDLE
★675C1-11	DRIVE GEAR SET 4H/5H
†★675C1-14	DRIVE GEAR SET 52H/6H
†★675C1-15	DRIVE GEAR SET 52L/6L

* PARTS REQUIRED FOR MODEL 534 ONLY

† PARTS REQUIRED FOR MODEL 548 ONLY

★ INCLUDES MOTOR DRIVE GEAR (See page 152) OR
(See page 153)



Eastman Cardinal Class 534, 548, and 562 Round Knife Machines Parts Lis

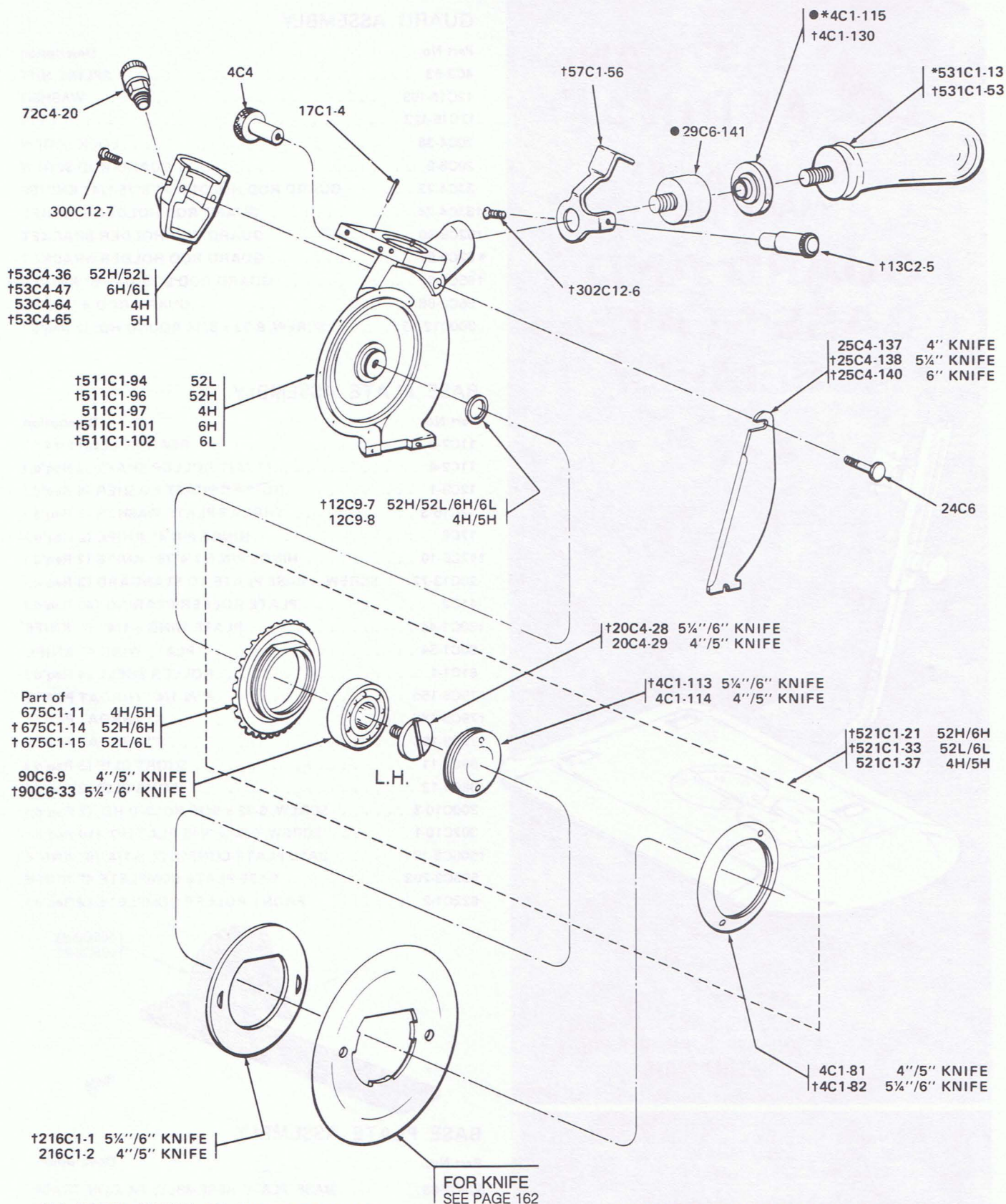



**ROUND KNIFE
MACHINES**

GUARD AND BASE PLATE ASSEMBLY

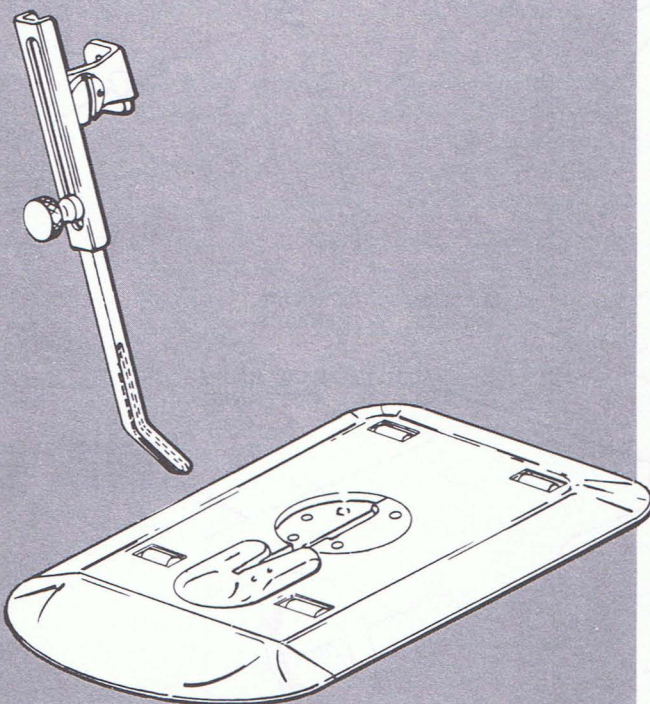

**PLEASE SPECIFY
MACHINE CLASS NUMBERS
AND SERIAL NUMBER WHEN
ORDERING PARTS**

ALL PARTS SHOWN ON EXPLODED PARTS
ILLUSTRATIONS ARE COMMON TO 548 AND
534 MODELS EXCEPT AS NOTED BY SYMBOLS.

*PARTS REQUIRED FOR MODEL 534 ONLY
†PARTS REQUIRED FOR MODEL 548 ONLY

GUARD ASSEMBLY

Part No.	Description
4C2-93	SPLINE NUT
12C15-103	WASHER
17C15-123	PIN
20C4-38	LOCK SCREW
20C5-2	GUARD ROD SCREW
33C4-23	GUARD ROD HOLDER 4"/5"/5-1/4" KNIVES
†33C4-24	GUARD ROD HOLDER 6" KNIFE
†62C9-80	GUARD ROD HOLDER BRACKET
*62C9-81	GUARD ROD HOLDER BRACKET
†65C2-67	GUARD ROD 5"/5-1/4"/6" KNIVES
65C2-66	GUARD ROD 4" KNIFE
300C12-13	SCREW, 8-32 x 5/16 ROUND HD. (2 Req'd.)

BASE PLATE ASSEMBLY

Part No.	Description
11C2-3	REAR ROLLER SHAFT
11C2-4	FRONT ROLLER SHAFT (2 Req'd.)
12C8-1	ROLLER SHAFT WASHER (8 Req'd.)
12C15-3	THROAT PLATE WASHER (2 Req'd.)
17C6	HINGE PIN 4" KNIFE (2 Req'd.)
†17C6-10	HINGE PIN 5-1/4"/6" KNIFE (2 Req'd.)
20C13-72	SCREW - BASE PLATE TO STANDARD (3 Req'd.)
41C2	PLATE ROLLER BEARING (40 Req'd.)
†60C1-44	PLATE WING 5-1/4"/6" KNIFE
60C1-54	PLATE WING 4" KNIFE
61C1-1	ROLLER SHELL (4 Req'd.)
†79C5-155	4"/5-1/4" THROAT PLATE
†79C5-184	6" THROAT PLATE
†79C5-185	5" THROAT PLATE
98C4-11	SHORT CLIP (2 Req'd.)
98C4-12	LONG CLIP (2 Req'd.)
300C10-3	SCREW, 6-32 x 5/16 ROUND HD. (2 Req'd.)
302C10-1	SCREW, 6-32 x 3/16 FLAT HD. (10 Req'd.)
†505C3-191	BASE PLATE COMPLETE 5-1/4"/6" KNIFE
505C3-203	BASE PLATE COMPLETE 4" KNIFE
622C1-2	FRONT ROLLER COMPLETE (4 Req'd.)

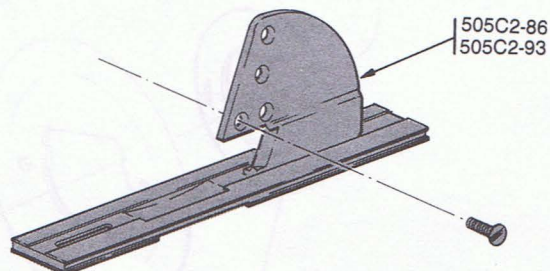

BASE PLATE ASSEMBLY

Part No.	Description
505C2-86	BASE PLATE ASSEMBLY, FALCON TRACK (534 4" BK / 548 4" BK)
505C2-93	BASE PLATE ASSEMBLY, FALCON TRACK (534 5" BK / 548 5" BK)



Eastman Cardinal Class 534, 548, and 562 Round Knife Machines Parts List

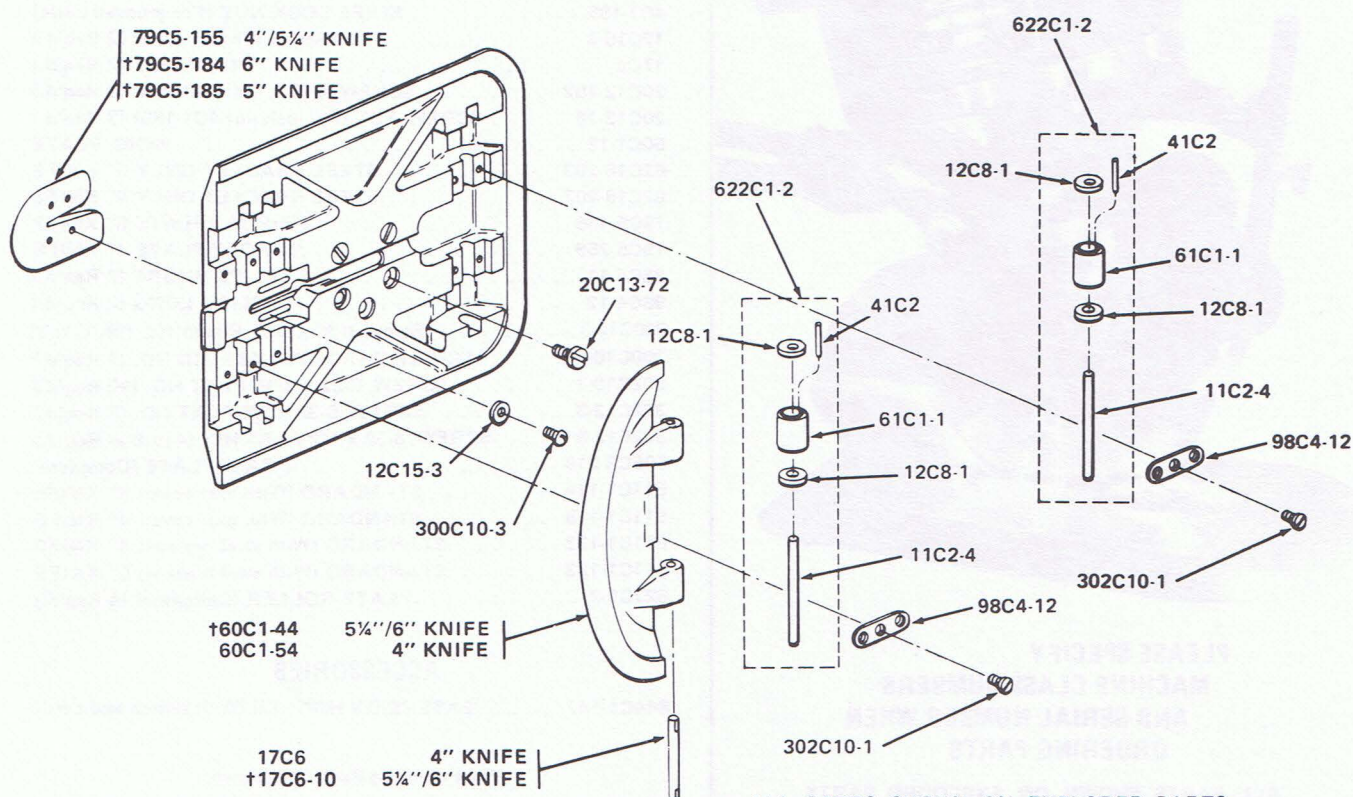
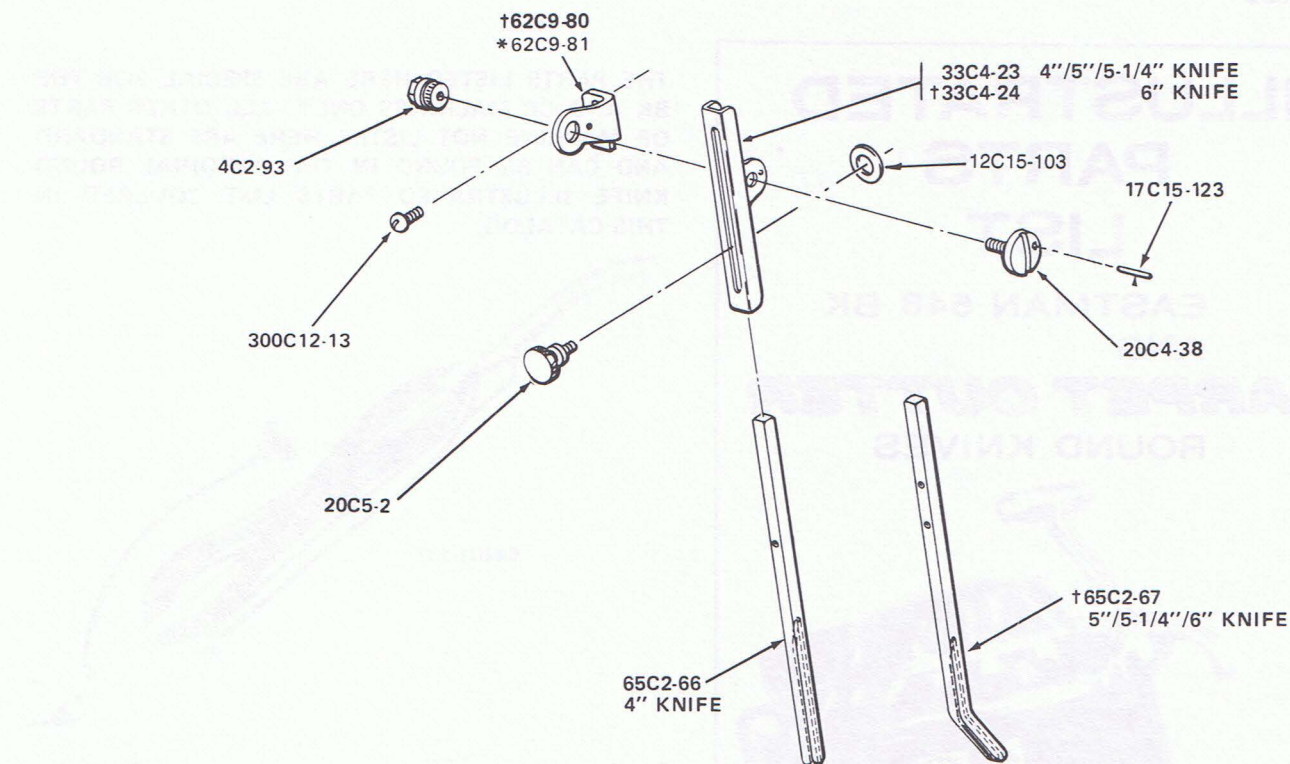

†505C3-191 BASE PLATE COMPLETE 5-1/4\"/>

ALL PARTS SHOWN ON EXPLODED PARTS ILLUSTRATIONS ARE COMMON TO 548 AND 534 MODELS EXCEPT AS NOTED BY SYMBOLS.

*PARTS REQUIRED FOR MODEL 534 ONLY
†PARTS REQUIRED FOR MODEL 548 ONLY

